

OUTLINE DIMENSION

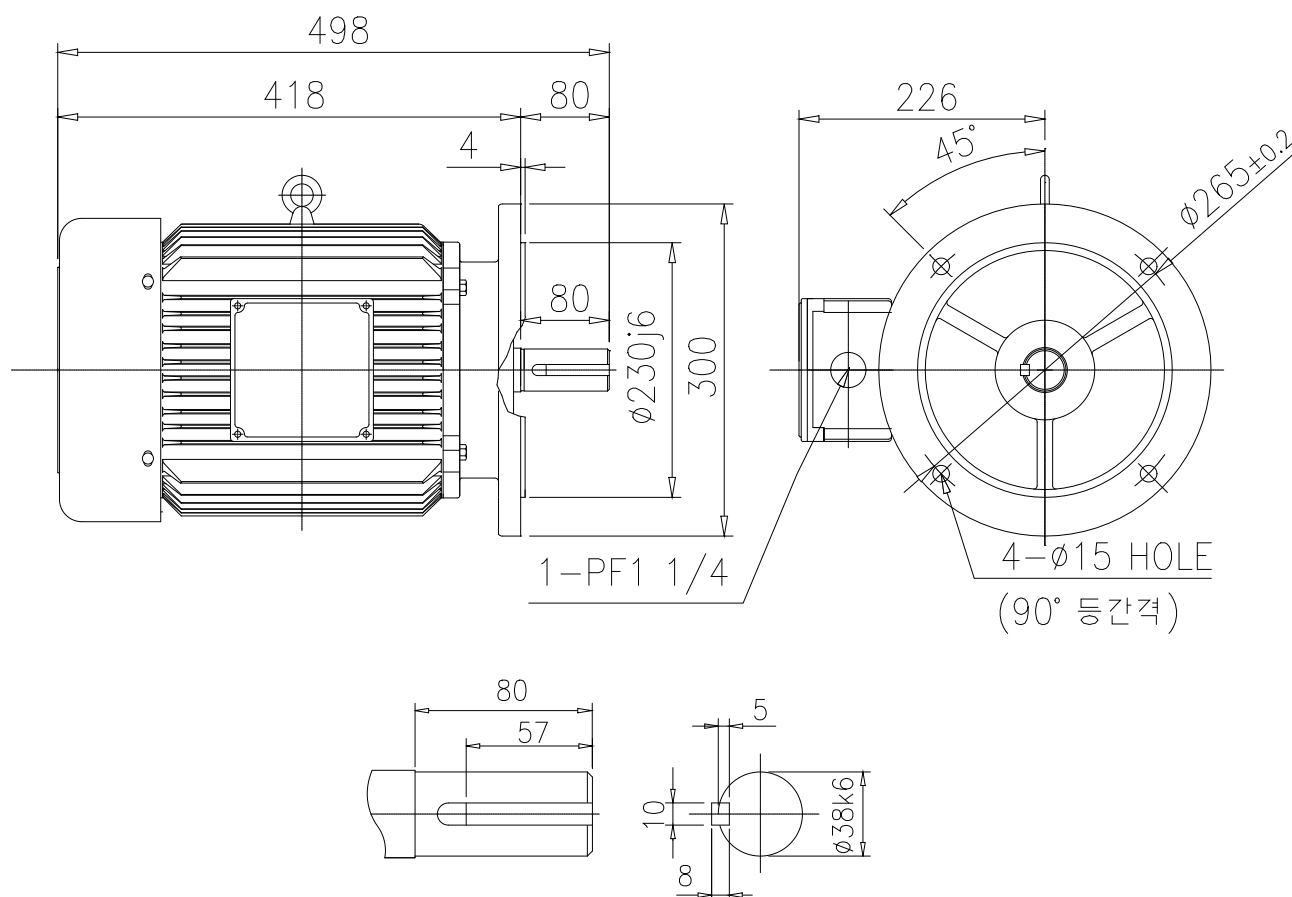

SHAFT EXTENSION

<NOTE>

1. TYPE : TEFC(Totally Enclosed Fan Cooled)
FOOTLESS MOUNTED TYPE
2. THE TOLERANCE FOR THE KEY DIMENSIONS
IS IN ACCORDANCE WITH KS B 1311-84
3. THE TERMINAL BOX MAY BE ROTATED
STEPS OF 90° MOUNTED TYPE

4. CAST IRON FRAME AND END BRACKETS.
5. STAINLESS STEEL NAME PLATE WITH
CONNECTION DIAGRAM.
6. STEEL FAN COVER AND
AL. TERMINAL BOX.

FLANGE NO.	OUTPUT (KW)				INS. CLASS	PRO-TEC-TION	RA-TING	BEARING NO.						APPROX. WEIGHT (Kg)		
								2 P		4 P		6P				
	2P	4P	6P	8P				DRIVE	OPP.D.	DRIVE	OPP.D.	DRIVE	OPP.D.	2P	4P	6P
FF265		7.5			F	IP54	CONT.			6208ZZ	6206ZZ			76		

UNIT	mm	SCALE	N/S	PROJECT'N	3rd Angle	TITLE	OUTLINE
DESIGNED		CHECKED		APPROVED			
2008.03.28 M.S.PARK		2008.03.28 J.H JO		2008.03.28 H.J.KIM		SUBJECT	FF265 V1
HIGEN Motor co., Ltd						DWG. NO.	DW-KMH-10HK1F